

# Lenovo ThinkPad E15 GEN 3

Primed and ready to take on almost any business task, the latest generation of ThinkPad E15 Gen 3 comprises everything you expect from a ThinkPad and everything you want from a modern notebook. Powerful AMD Ryzen™ 5000 Series mobile processors deliver state-of-the-art performance, with the choice of two AMD family offerings to suit any requirement.

Stylish Aluminum top cover, razor-thin bezels, and built-in Bluetooth earbuds<sup>1</sup> make it truly user-focused. MIL-SPEC testing and robust security ensure data and device are protected. Take on all you can handle and more on ThinkPad E15 Gen 3.

<sup>1</sup>Optional

AMD  
RYZEN

Smarter  
technology  
for all

Lenovo



# Lenovo ThinkPad E15 GEN 3

## AMD RYZEN



### DOMINANT PROCESSING TECHNOLOGY

Equipped with the latest AMD Ryzen™ 5000 U-series mobile processors, the ThinkPad E15 Gen 3 delivers benchmark performance<sup>1</sup> in a business PC. Built on the new AMD Zen 3 architecture, the U-series mobile processors lower system latency and accelerate overall computing, so you can power through every task.



### ADVANCED USER EXPERIENCE

Get uncompromised visuals on the 1080p, 100% sRGB IPS<sup>2</sup> panel that ensures detail and clarity, while up to 300nits of brightness lets you view its contents outdoors or in brightly-lit environments. ThinkPad Glance technology, using the IR camera<sup>2</sup> for face, eye, and gaze-tracking, offers Snap Window, Presence Detection, and Smart Pointer functions for a seamless navigation experience.



### SPLENDID DESIGN

Designed to look the part in any business scenario, the E15 Gen 3 is a professional PC that appeals to the modern workforce thanks to its slim build and Aluminum top cover. It weighs 1.7kg and is only 18.9mm thin, so you can take it anywhere. A screen-to-body ratio of 85% gives you a premium-looking screen without thick bezels to weigh it down. Moreover, the device is MIL-SPEC tested, making it durable and reliable in equal measure.



### ENHANCED CONFERENCING

Now keep your earbuds handy everywhere you go. Integrated wireless earbuds<sup>2</sup> come housed in the Versa Tray on the E15 Gen 3. Precise sound-quality and allowing for over 2 hours of uninterrupted phone calls make these Bluetooth earbuds perfect for impromptu meetings. They auto-connect to the PC once removed from the tray, adding convenience, while the dual-mics provide Environmental Noise Cancellation (ENC). Additionally, physical Hot Keys let you answer and hang up on calls with a single press.



## performance

The latest generation AMD Ryzen™ 5000 U-series mobile processors are powerful enough to handle heavy-duty tasks like content creation and graphic design. Dual SSD storage and up to 24GB DDR4 memory ensure lightning-fast responsiveness and a smooth computing experience.

## connectivity

A wide array of ports, including HDMI, RJ45, and three USB ports, enable connections to multiple external devices. Adding flexibility and convenience, the full-function USB Type-C offers data, power, video, and audio transfers from a single port. Wi-Fi 6<sup>2</sup> compatibility ensures a higher network speed and broader bandwidth.

## security

The data and device are safeguarded with multiple security features on the E15 Gen 3. Log in instantly with facial recognition using the IR camera,<sup>2</sup> or with the FPR integrated<sup>2</sup> on the power button. Maintain webcam privacy by simply sliding the ThinkShutter camera cover when not in use.



HARMAN stereo speakers and Dolby® Audio™



85% STBR design with up to 100% sRGB, 300nits display

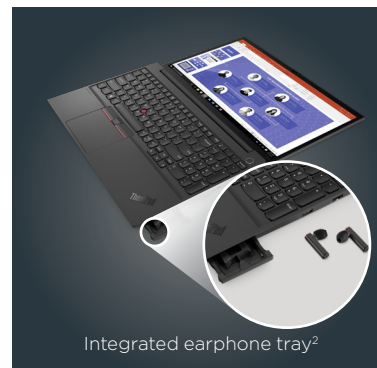

Integrated earphone tray<sup>2</sup>



Full-function USB Type-C, HDMI, and more

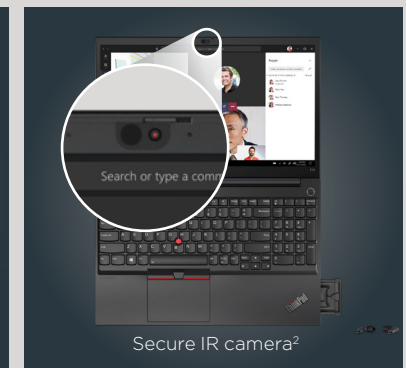

Secure IR camera<sup>2</sup>

<sup>1</sup>Testing by AMD Performance Labs as of 12/30/2020 using PCMark10, PCMark Apps (App Performance Overall), Word, Excel, Powerpoint, Edge to measure the productivity performance of Ryzen 7 4800U vs. Core i7-1165G7, a Ryzen 7 5800U, vs. Core i5-1135G7, and a Ryzen 3 5400U vs. Core i3-1115G4. Results may vary. PC Mark is trademark of UL LLC.  
<sup>2</sup>Optional

Lenovo

# performance

**PROCESSOR**  
Up to AMD Ryzen™ 5000 Series mobile processors

**OPERATING SYSTEM**  
Up to Windows 10 Pro

**GRAPHICS**  
Integrated AMD Radeon™ graphics

**CAMERA**  
HD, HD+IR camera, ThinkShutter  
Dual array mics

**MEMORY**  
Up to 24GB DDR4, 3200MHz  
(on board + single SoDIMM)

**STORAGE**  
SSD 1: Up to 1TB SSD M.2 PCIe  
SSD 2 (optional): Up to 512GB SSD M.2 PCIe

**BATTERY**  
45Whr / 57Whr

**AC ADAPTER**  
Up to Type-C 65W (supports RapidCharge)

**AUDIO**  
2 x 2W HARMAN-branded stereo speakers  
Dolby® Audio™  
Integrated Bluetooth earbuds¹

# connectivity

**INPUT/OUTPUT PORTS**  
1 x USB Type-C 3.2 Gen1 (with DP and PD)  
1 x USB 3.2 Gen1 (always-on unit)  
1 x USB 2.0  
1 x HDMI 1.4b  
1 x RJ45  
1 x combo mic/audio

**WLAN**  
Up to Wi-Fi 6  
Up to Bluetooth® 5.2

**DOCKING**  
ThinkPad USB-C Dock Gen2  
Hybrid USB-C Dock



# security

Smart Power On (Integrated FPR on power button)¹  
ThinkShutter camera cover  
Kensington™ lock slot

# design

**DISPLAY**  
15.6" FHD (1920 x 1080) TN with anti-glare  
15.6" FHD (1920 x 1080) IPS, 300nits, with anti-glare  
15.6" FHD (1920 x 1080) IPS, 300nits, 100% sRGB, with anti-glare

**DIMENSIONS (W X D X H)**  
365 x 240 x 18.9mm  
14.37 x 9.44 x 0.74 inches

**WEIGHT**  
Starts at 1.70kg/3.75lbs.

**KEYBOARD**  
Full-sized with full number keys,  
Button TrackPad, backlight¹  
VoIP Hot Keys²

**COLORS**  
Black

**USER EXPERIENCE**  
Smart Power On¹  
Integrated wireless earbuds with Versa Tray¹

# optional services

Lenovo offers a comprehensive portfolio of services to support and protect your ThinkPad investment—so you can focus on your work, not your IT.

**PREMIER SUPPORT**  
Provides direct access to skilled and experienced Lenovo technicians offering comprehensive hardware and software support. Gives you a consistent point of contact within Lenovo to ensure that your case resolution is professionally managed from start to finish.

**ACCIDENTAL DAMAGE PROTECTION (ADP)**  
Prevents the hassles of unexpected repair costs. Provides coverage for non-warranted damage incurred under normal operating conditions, such as minor spills, drops, or damage to the integrated screen.

**WARRANTY EXTENSION (1-YEAR BASE, UP TO 3 YEARS TOTAL)**  
This fixed-term, fixed-cost service helps you accurately budget for PC expenses, protect your valuable investment, and lower the cost of ownership over time.

¹Optional  
²Requires Skype for Business account, not pre-installed by Lenovo.

# accessories



**THINKPAD BLUETOOTH LASER MOUSE**  
PN: 0A36407 / 0A36408  
The portable, ambidextrous ThinkPad Bluetooth Laser Mouse is perfect for everyday and on-the-go use. It delivers extraordinary control on virtually any surface. Scroll through documents, spreadsheets, and more with increased accuracy and control with its high definition laser sensor and tilting scroll wheel.



**LENOVO 100 STEREO USB HEADSET**  
PN: 4XDX88524  
An on-ear business-ready stereo USB Headset with a rotatable boom microphone and passive noise cancellation, perfect for calls and music. Its memory foam and leather earcups make it light and comfortable enough to wear and use all day. 30 mm drivers with neodymium magnets deliver excellent audio for calls and music, while its adjustable headband and boom mic allow either left-side or right-side wearing.



**THINKPAD ESSENTIAL PLUS 15.6-INCH BACKPACK (ECO)**  
PN: 4X41A30364  
With the perfect blend of professionalism and athleticism, the ThinkPad Essential Plus 15.6" Backpack (Eco) can take you from the office to the gym and back with ease. Spacious compartments keep your devices and essentials secure, organized, and accessible, while ballistic nylon and rugged hardware protect against the weather and daily wear.

© 2021 Lenovo. All rights reserved. These products are available while supplies last. Prices shown are subject to change without notice. For any questions concerning price, please contact your Lenovo Account Executive. Lenovo is not responsible for photographic or typographic errors. Warranty: For a copy of applicable warranties, write to: Warranty Information, 500 Park Offices Drive, RTP, NC 27709, Attn: Dept. ZPYA/B600. Lenovo makes no representation or warranty regarding third-party products or services. Trademarks: Lenovo, the Lenovo logo, Rescue and Recovery, ThinkPad, ThinkCentre, ThinkStation, ThinkVantage, and ThinkVision are trademarks or registered trademarks of Lenovo. Microsoft, Windows, and Vista are registered trademarks of Microsoft Corporation. AMD, the AMD Arrow logo, and combinations thereof are trademarks of Advanced Micro Devices, Inc. in the United States and/or other jurisdictions. Other company, product, and service names may be trademarks or service marks of others.

